

Step 4

From the hardware bag included:

Remove the split washer, the flat washer and the large bolt.

(1.) Place the split washer onto the bolt first followed by the flat washer.

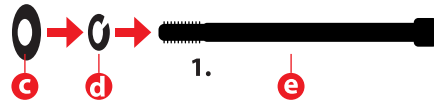

(2.) Attach the stock to the shotgun using this bolt and the supplied L-wrench.

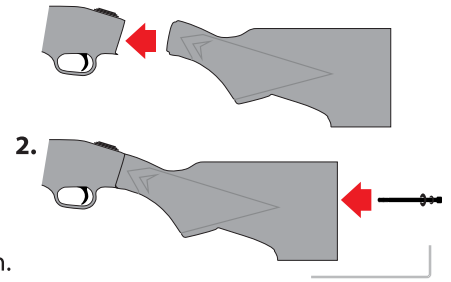

Step 5

Place the magazine spring assembly back inside the stock ensuring it is completely seated inside the magazine well.

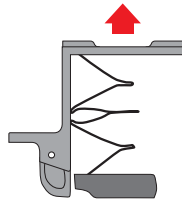

Step 6

Using one of the two 3/4 inch Philips head screws provided in the hardware bag (b), fasten the front of the spring-loaded shell retainer to the stock.

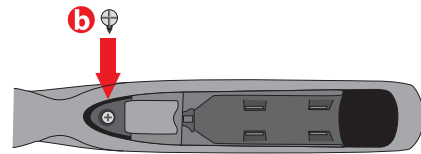

Step 7

(1.) Replace the rear insert you removed in Step 2 and (2.) secure with the other 3/4 inch Phillips head screw (b)

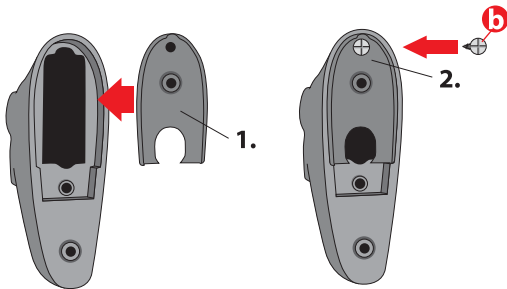

Step 8

! STEP 8 NOTE: (optional)

If you will only be utilizing 2 3/4" or 3" shells, leave the magazine spacer connected to the lower magazine assembly. (a.)

If you will only be utilizing 3 1/2" shells, remove the spacer from the lower magazine assemble and store in a secure location. (b.)

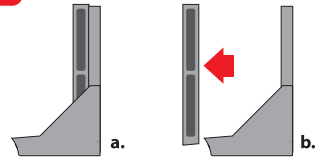

(1.) Place the lower magazine assembly inside the stock.
(2.) Secure the assembly at the rear of the stock with the 8-32 x 1/2" screw you removed in Step 2.

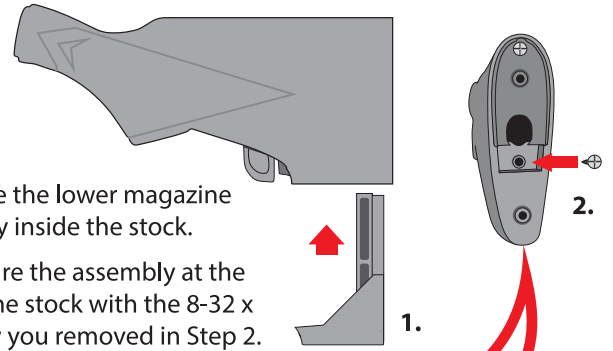

Step 9

Place recoil pad onto the rear of the FLASH-5 stock and secure with the two 1 1/4 inch Philips head screws (a) from the hardware bag.

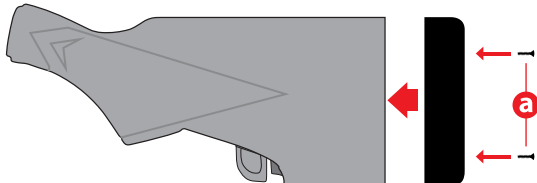

IMPORTANT:

Ensure the lower magazine assembly is properly seated or the retention screw will not engage the assembly.

NOTE: When loading shotgun shells into the magazine, **always load with brass head facing outward**, towards the retainer. Loading shells brass side facing inward may result in the shells becoming jammed.



For more information or for further assistance:

Visit our website at: www.TactaLoad.com

Call us Toll-Free at: 1-(800) 676-4816 or Email us at: info@tactaload.com